

100W Solar Camper Wiring Diagram

HighCaliberCamping.com

NOTE: This wiring diagram shows how to assemble a basic 100W solar electrical system for your camper. Included is a roof fan, an exterior LED light and interior LED light (both on switched power), and a 5V USB socket for charging devices on the go. You can add or subtract 12VDC devices as needed, as long as your total 12V DC current usage stays under 30A.

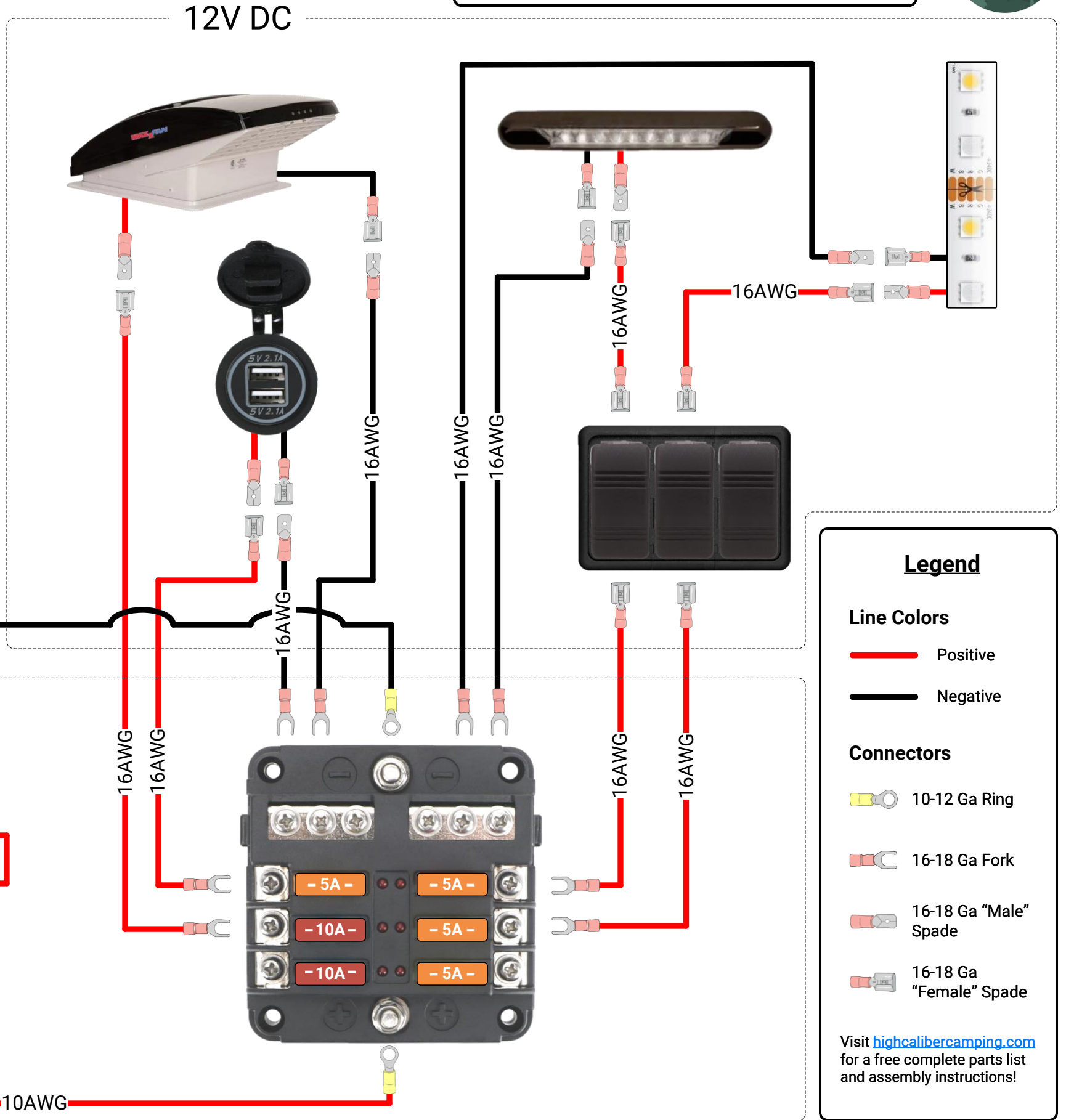
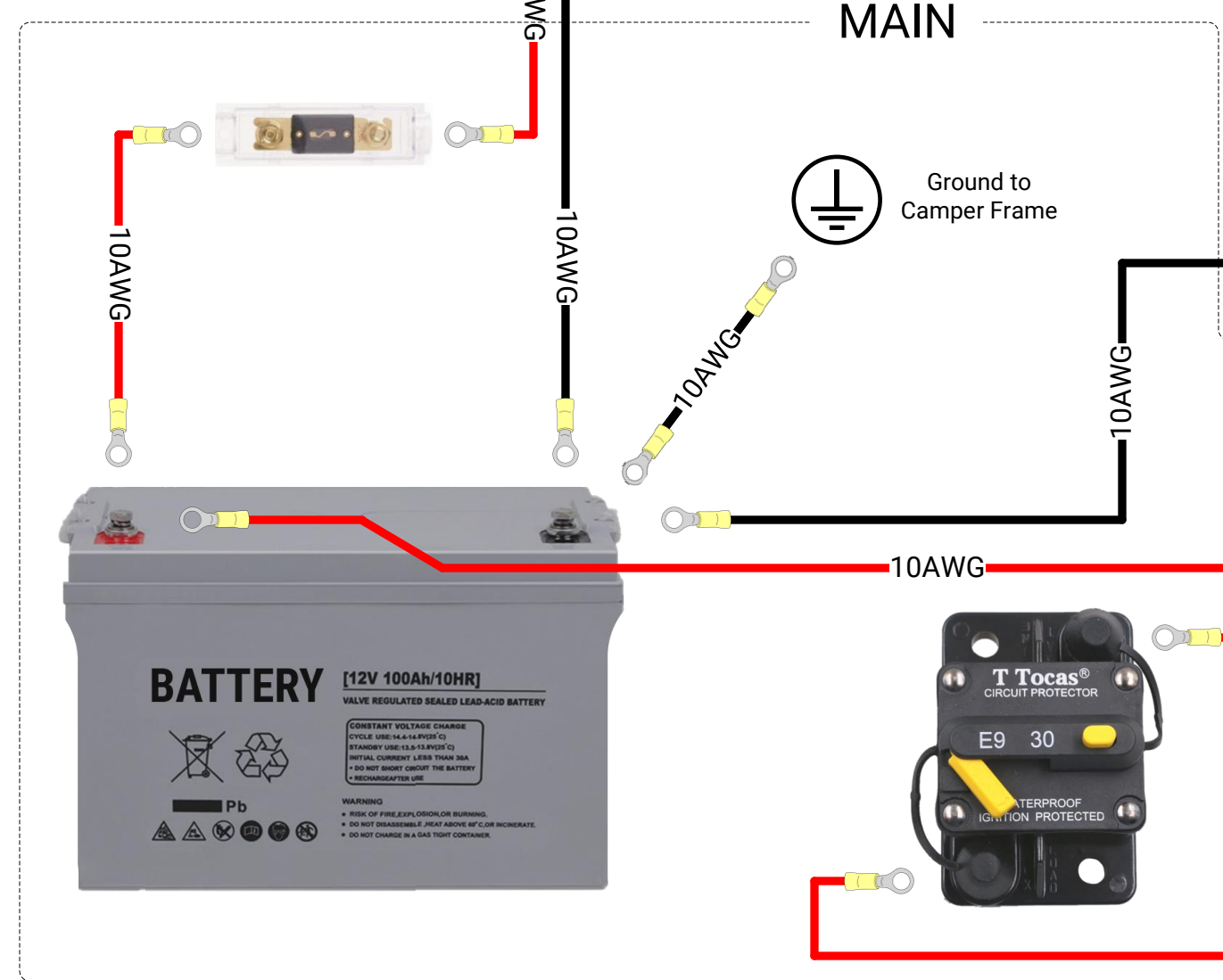
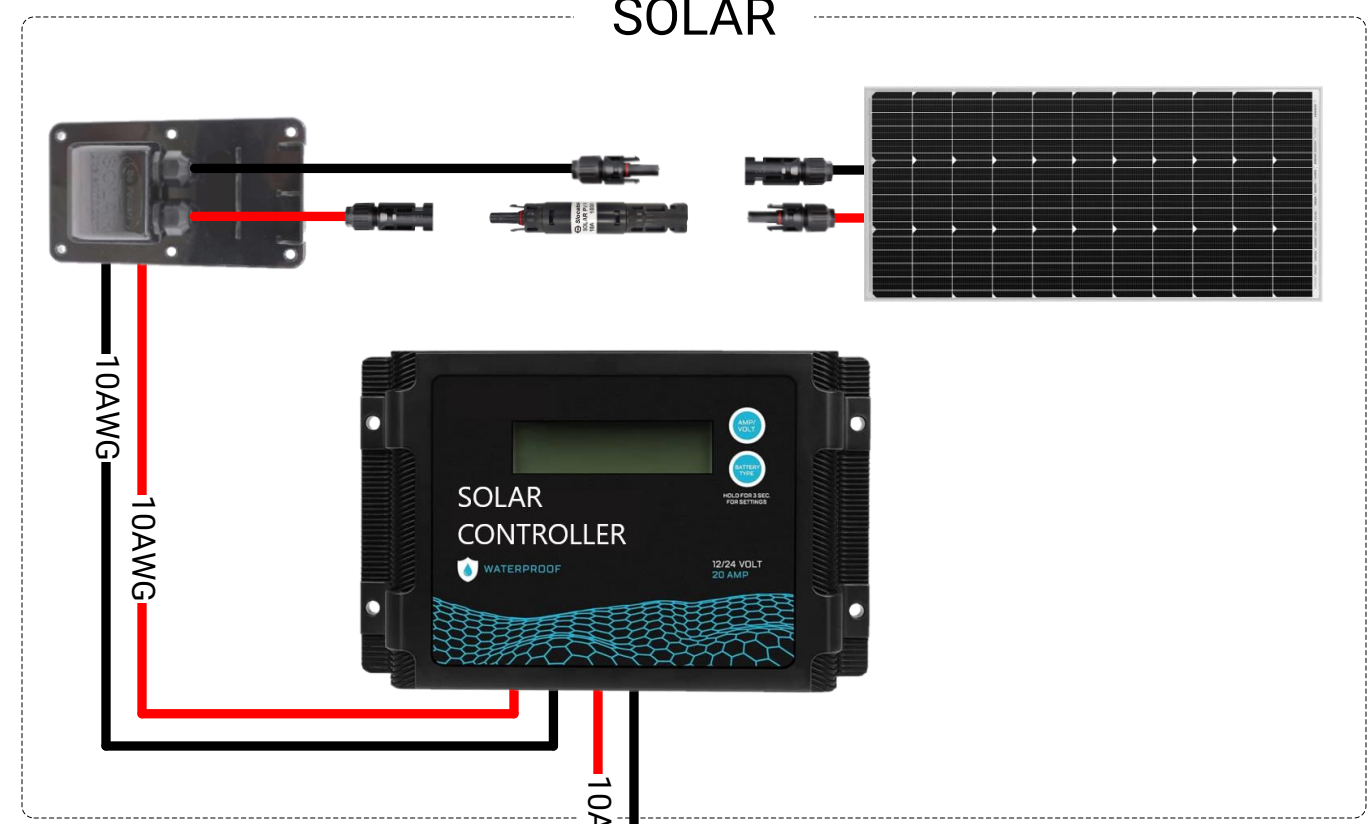

Legend

Line Colors

- Positive (Red line)
- Negative (Black line)

Connectors

- 10-12 Ga Ring
- 16-18 Ga Fork
- 16-18 Ga "Male" Spade
- 16-18 Ga "Female" Spade

Visit highcalibercamping.com for a free complete parts list and assembly instructions!

100W Solar Camper Wiring Diagram

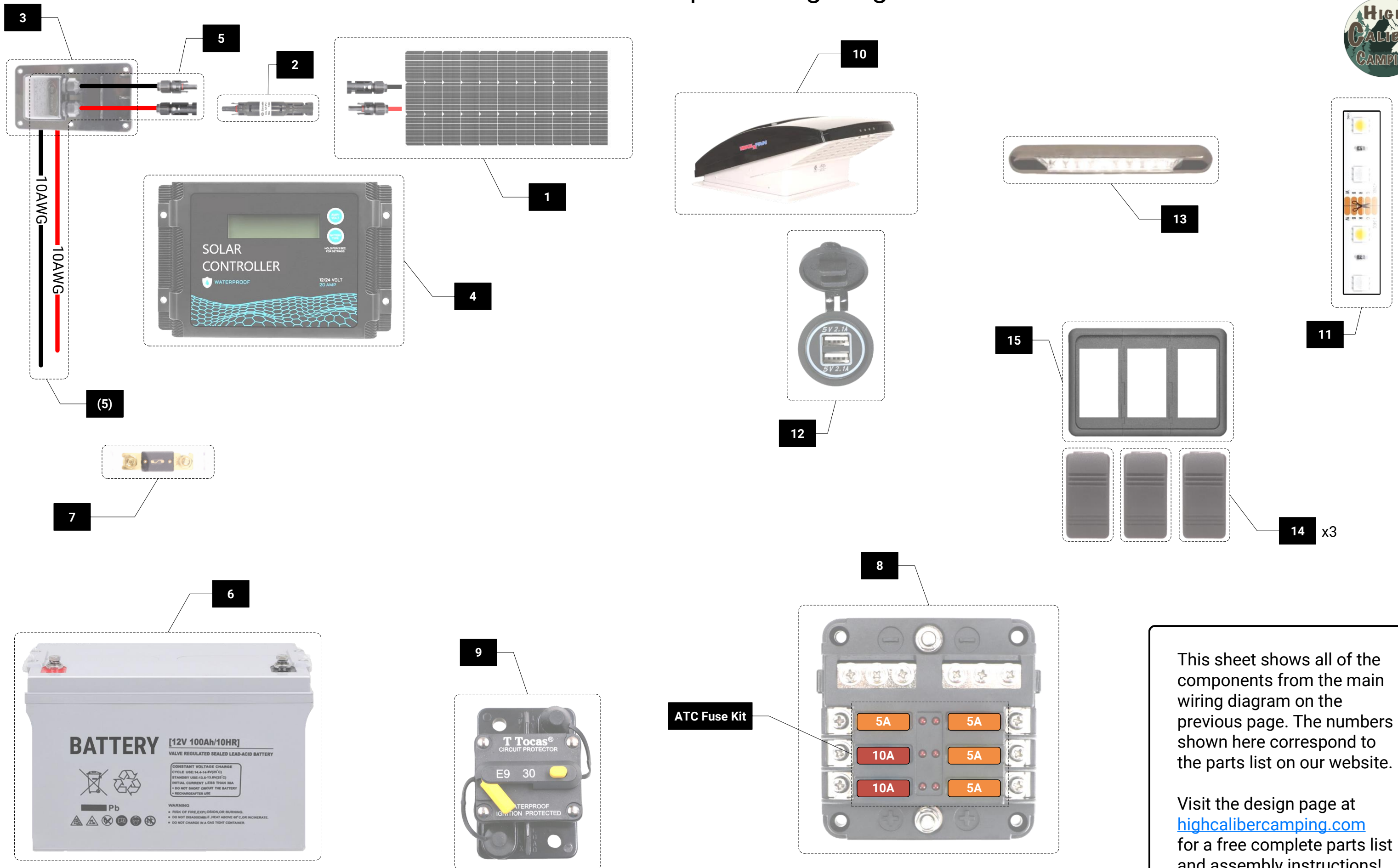

This sheet shows all of the components from the main wiring diagram on the previous page. The numbers shown here correspond to the parts list on our website.

Visit the design page at highcalibercamping.com for a free complete parts list and assembly instructions!